



merlin magic - hand held

Features and advantages of the product



IDS - merlin electronic
 Franz-Zell-Straße 6
 D 82211 Herrsching

Tel.: ++49 (0) 81 52 / 91 84 48
 Fax: ++49 (0) 81 52 / 91 84 59

e-mail: info@merlin-electronic.de
 Internet: www.merlin-electronic.de

Configuration

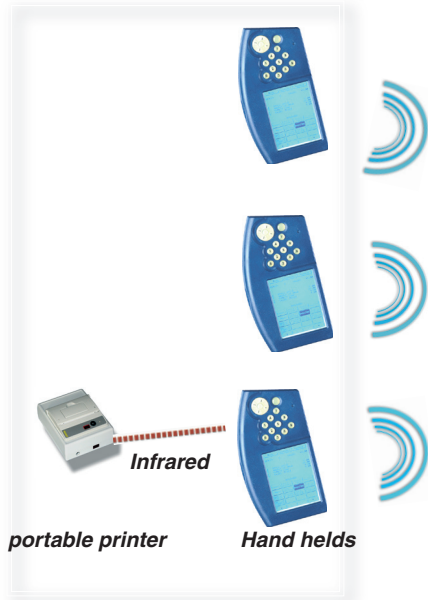

merlin magic

- up to 16 hand holds in one radio base
- Range 50 -200 m
- direct integration with the infrared printer

Radio

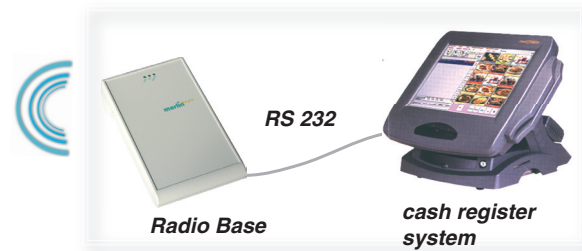

merlin magic - configuration with several areas and Roaming

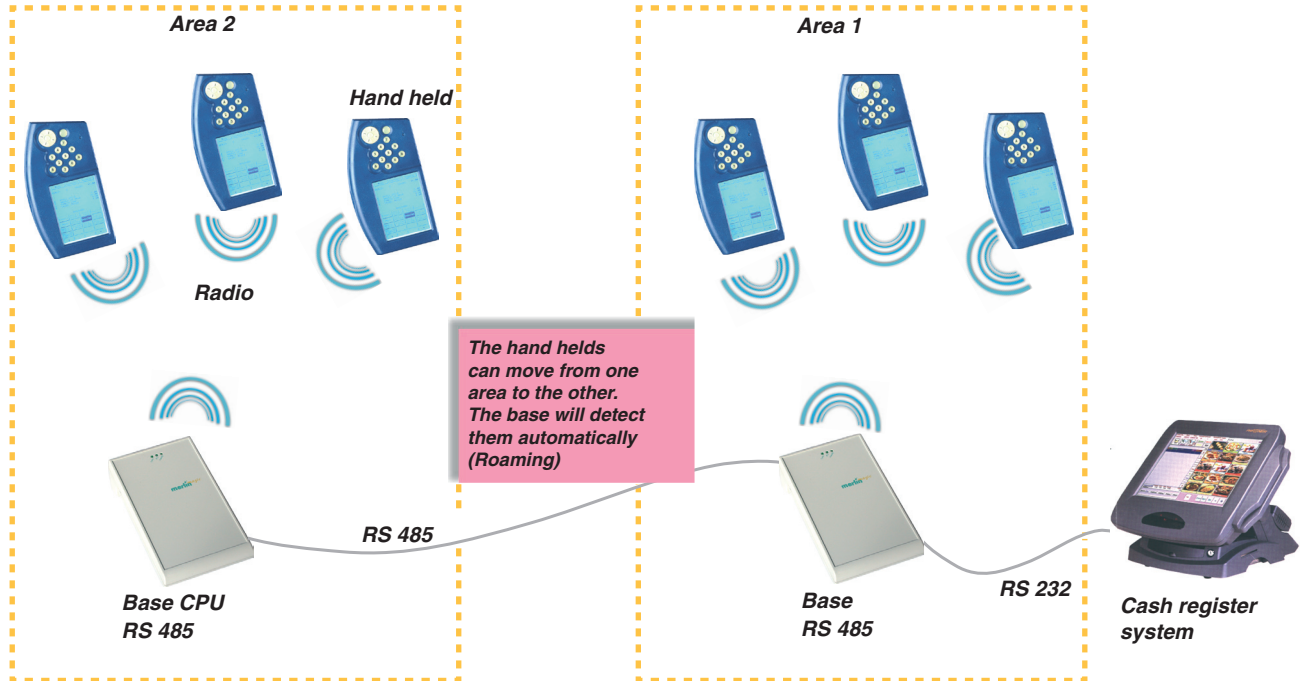

Data flux

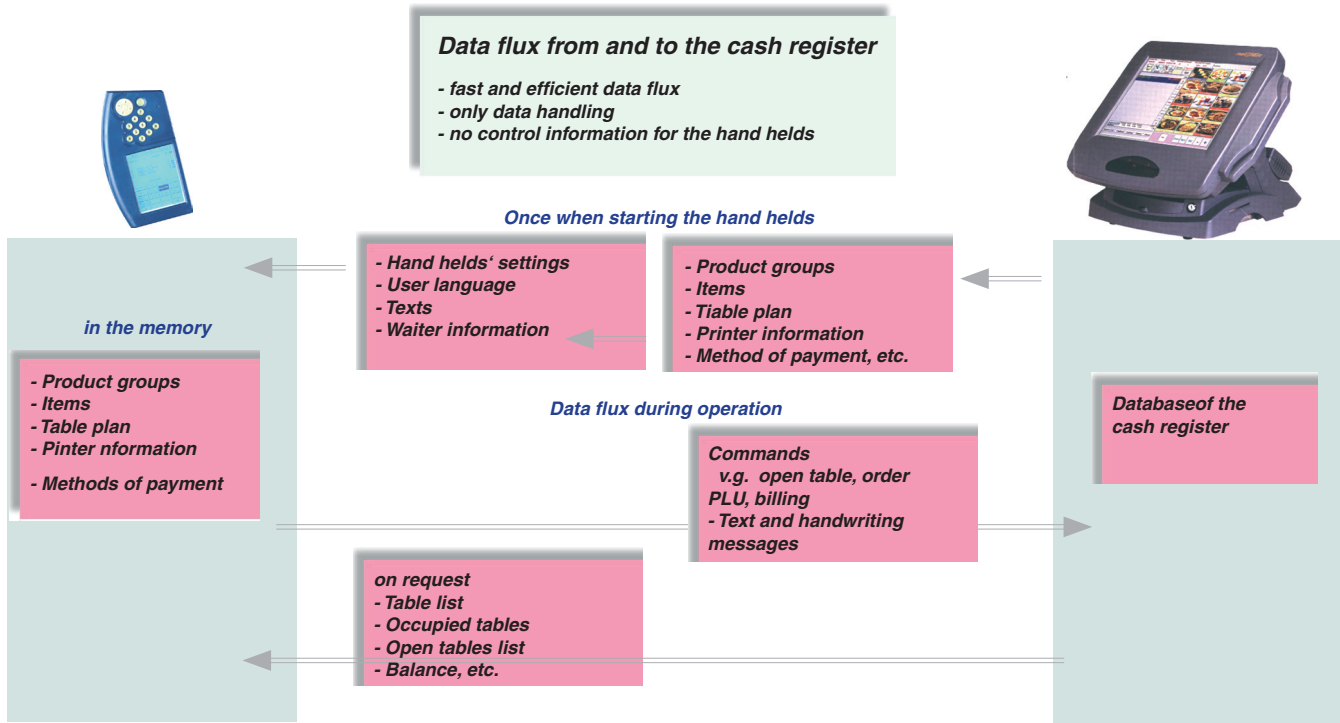

due to all this - a very fast data transfer

Hardware features



Ergonomic design

Large display

Keypad for PLU-numbers

One-handed operation

Multifunction key

Shockproof

Watertight

Display and Keypad

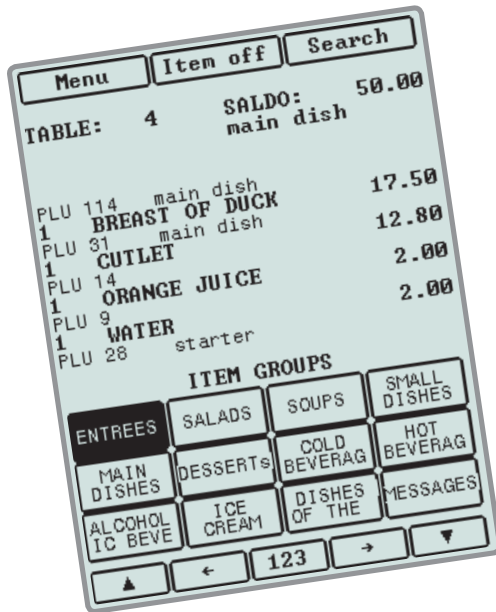

Good display illumination

Automatic illumination switch-off

Automatic contrast control

Key board - blind ordering possible



Keypad



Multifunction key

Special key

Ten-digit keypad

Ergonomics



one-handed

two-handed

with stylus

Display

Menu	Item gr.	Search
FUNCTIONS		
Item Groups	Off	ACC
Book over	Splitting	Tables in use
Draw		
Waiter		
Servin order		
SMS		
4		
TABLE Room GUEST Servin g order		
PLU	Price	* -

Menu	Item off	Search
TABLE:	4	SALDO: 50.00
		main dish
PLU 114	main dish	
1	BREAST OF DUCK	17.50
PLU 31	main dish	
1	CUTLET	12.80
PLU 14		
1	ORANGE JUICE	2.00
PLU 9		
1	WATER	2.00
PLU 28	starter	
ITEM GROUPS		
ENTREES	SALADS	SOUPS
SMALL DISHES		
MAIN DISHES	DESSERTs	COLD BEVERAG
HOT BEVERAG		
ALCOHOL IC BEVE	ICE CREAM	DISHES OF THE
MESSAGES		
▲ ← 123 → ▼		

Main functions

Function keys

Keypad for PLU-numbers

Status line

Ordering list

Fast-orders buttons

Scroll line / Ten-key keypad buttons

Display - Product groups- Fast-orders buttons

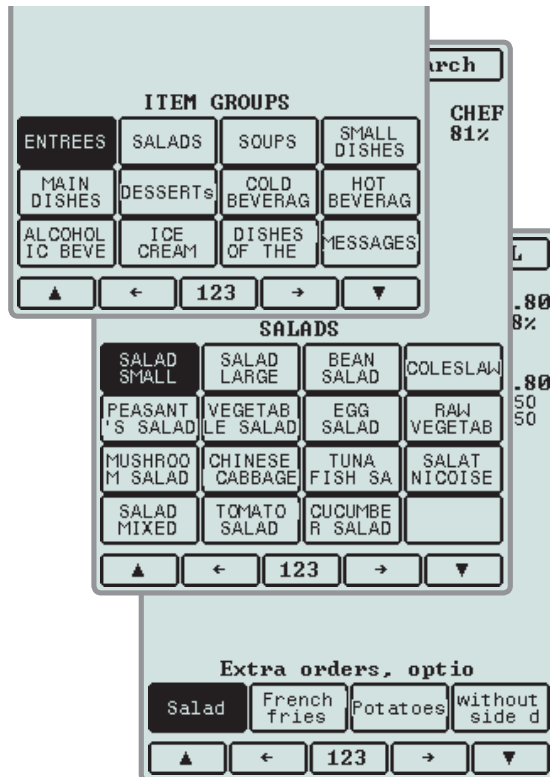

Fast-orders buttons in the display

Summary of product groups in the display

easy change of product groups

flexible assignment of fast-orders buttons

16 or 32 fast-orders buttons representable

Scrolling in the product groups

Buttons for side-dishes appear autom.

Display - Representation - Operation

Menu	ACC	Split End
TABLE: 8	SALDO:	55.70
GUEST: 1/1	Splitting	
1 WINE RED		3.00
1 BREAST OF DUCK		17.50
1 RISOTTO		7.80
GUEST 1: 27.40		
1 BEER" 0,3		2.00
1 ROAST GOOSE		17.20
1 TOMATO MOZZARELLA		9.20

PLU end	order end	CANCEL		
TABLE: 7		CHEF 90%		
1 ICE CREAM SMALL		10.70		
Raspberry		1.00		
Strawberry		1.20		
Chocolate		1.00		
Whipped cream		1.50		
Extra orders, oblig				
Raspber ry	Strawbe rry	Whipped cream	Chocola te	
Nut				
▲	←	123	→	▼

Clear representation

well-conceived user's guide

full functionality

Operation always possible with one finger

Character size adjustable

Languages switchable

Main functions

Menu	Item gr.	Search
FUNCTIONS		
Item groups	Off	ACC
Book over	Splitting	Tables in use
Draw	Settings	History
Waiter	On / Off-line	User
Serving order	Finish	price level
SMS		

▲ ← 123 → ▼

Product groups / Items

CASH

Book-over

Splitting

Open-tables list

Table plan

Draw

Waiter change

Serving order

Price levels

User

Options



Infrared interface



Transponder Read/write

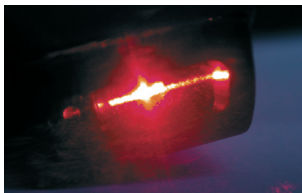

Bar-code reader

Accessories



Carrying bag



Security cord



Portable printer / Carrying bag

Putting into operation



Can be put into operation within a couple of minutes

automatic adoption of the items by the cash-register system

no installation of representation and fast-orders buttons

automatic adoption of waiter's settings

Radio



Assignment basis – hand-held unit

Roaming

Frequency hopping–automatic frequency selection

European authorization

European authorization

Advantages for the guests / customers



Less staff required

Speedier service at rush hours

Shorter intervals for occupied tables

No waiter's cheat possible

More consumption – especially beverages

More turnover

Less stress for the waiting staff

Clients / customers that are more satisfied

